

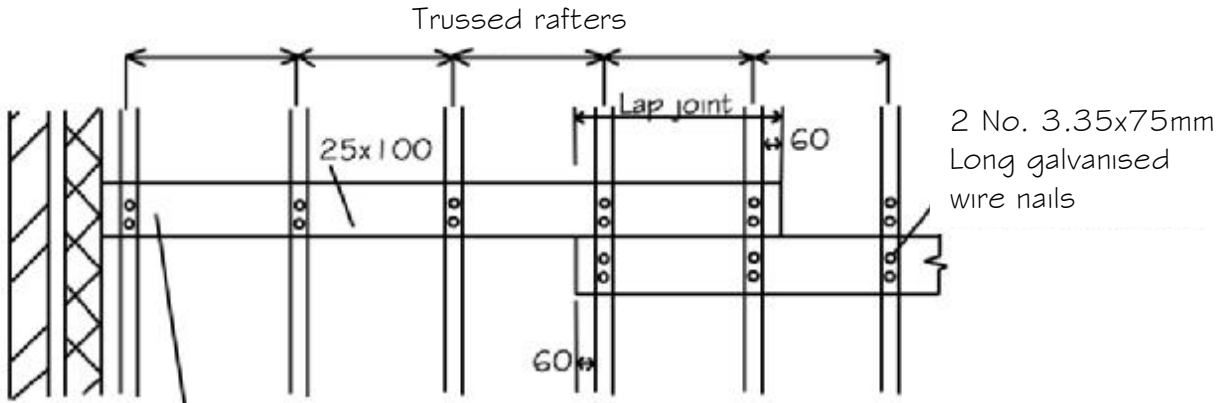



Longitudinal Stability Bracing

PLAN ON X-X AT END WALL.



Longitudinal bracing to be fixed to or in firm contact with end wall.

25x100 longitudinal bracing to be provided at all unsupported node points as shown  and run continuously through parallel trusses along the entire length of the building and fixed to each truss by two 3.35x75mm long galvanised wire nails. Where necessary bracing to be lap jointed over at least two trusses.

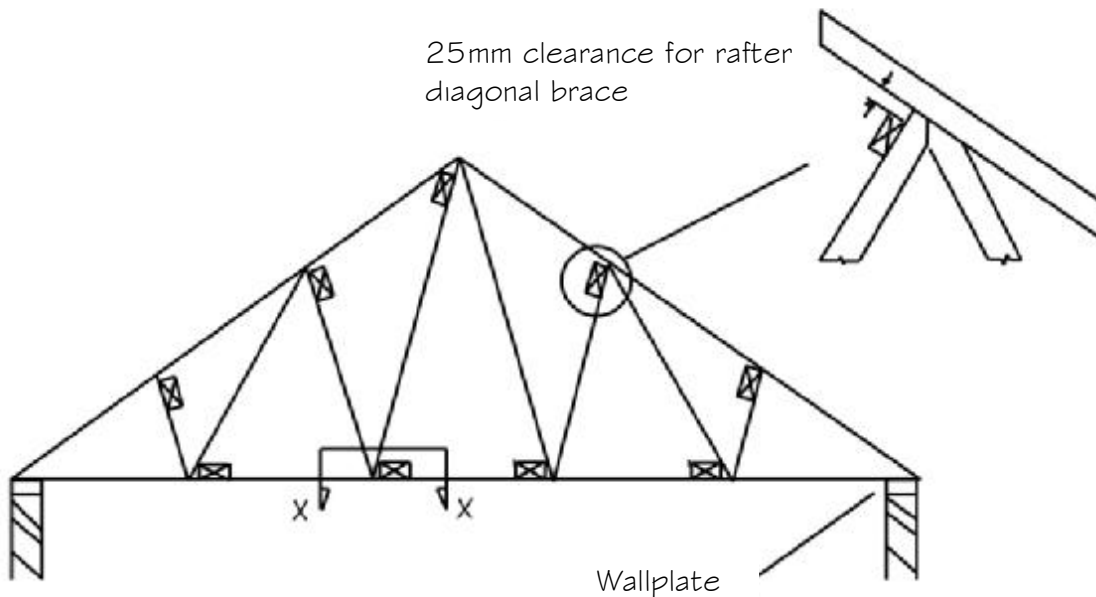

Other bracing omitted for clarity